



Aero Series
Commercial Energy Saver
Multi Flue Oil-Powered Models
CF-38-3 CF-80-3 CF-100-3

Features:

- **Automatic Controls**—Single aquastat (shipped with burner) with mechanical control monitors tank temperature through upper and lower ports. Provides more uniform result for controls. (CF-80 and CF-100). Electronic control aquastat on CF-38 with built-in high limit.
- **Vitraglas® Lined Tank**—Water heater tanks are protected from the corrosive effects of hot water by an exclusive ceramic porcelain-like coating. Our high silica Vitraglas® lining provides a tough interior surface for water heater tanks, which must withstand the wearing effects of high volume and high temperature hot water.
- **Factory Installed Hydrojet® Sediment Reduction System**—Cold inlet sediment reduction device made of stainless steel for increased durability. Helps prevent sediment build up in tank.
- **Magnesium Anode Rods**—Employed to provide an extra measure of corrosion prevention for longer life.
- **Non- CFC Foam Insulation**—Saves energy by retarding heat loss. Also increases tank rigidity.
- **Hand Hole Cleanout**—Allows inspection of tank interior and facilitates removal of water heater's principal deterrent to long life—accumulated lime and sediment deposits.
- **Brass Drain Valve.**
- **T&P Relief Valve**—Installed.
- **ASME Code Construction**—Available on 80 and 100 gallon (303 and 379 liters) models, not available on 38 (144 liter) gallon models.
- **38, 80 and 100 Gallon (144, 303 and 379 Liter) Storage Tank.**
- **Three Year Limited Warranty on Steel Tank**—Heavy gauge steel automatically formed, rolled and welded to assure a continuous seam for glass lining.
- **One Year Limited Warranty on Parts and Burner.**
- **Design Certified by ULC. Burners are UL listed.**



MANUFACTURED UNDER ONE OR MORE OF THE FOLLOWING U.S. PATENTS: 7,063,133 B2; 5,954,492; 5,954,492; 5,761,379; 5,943,984; 5,081,696; 5,988,117; 6,142,216; 5,199,385; 5,574,822; 5,372,185; 5,485,879; 5,277,171; (B1)5,341,770; 5,660,165; 5,596,952; 5,682,666; 4,904,428; 5,023,031; 5,000,893; 4,669,448; 4,829,983; 4,808,356; 5,115,767; 5,092,519; 5,052,346; 4,416,222; 4,628,184; 4,861,968; 4,672,919; Re. 34,534. OTHER U.S. AND FOREIGN PATENT APPLICATIONS PENDING. CURRENT CANADIAN PATENTS: 1,272,914; 1,280,043; 1,289,832; 2,045,862; 2,112,515; 2,108,186; 2,107,012; 2,092,105.

Vitraglas® and Hydrojet® are registered trademarks of Bradford White® Corporation.

Commercial Energy Saver Multi Flue Oil-Powered Models

CF-38 / CF-80 / CF-100

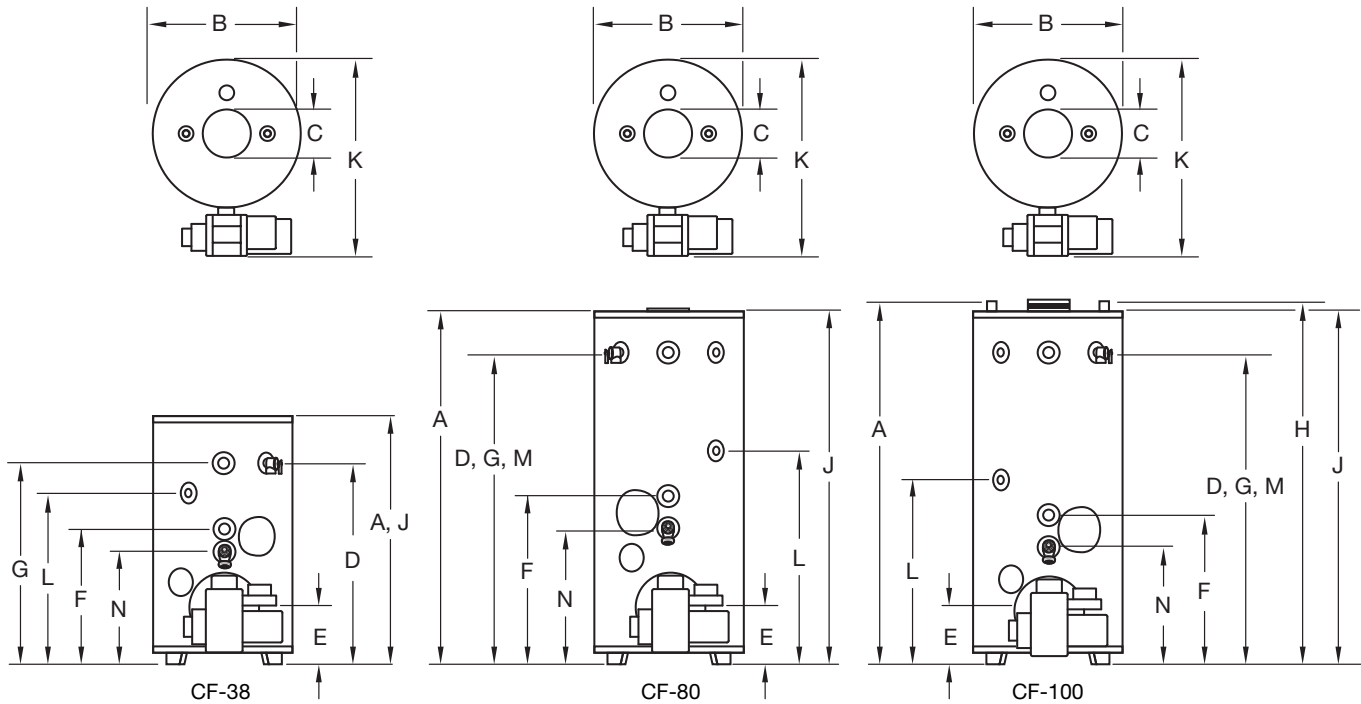

Energy Saver Models

Oil

Meet or exceed ASHRAE 90.1b (current standard) C.E.C. Listed
80% Recovery Efficiency

Model Number	A Floor to Flue Conn. in.	B Jacket Dia. in.	C Vent Size in.	D Floor to T&P Conn. in.	E Floor to C/L Burner Opening in.	F Front / Rear Cold Water Conn. in.	G Front / Rear Hot Water Conn. in.	H Floor to Top Water Conn. in.	J Floor to Heater Top in.	K Depth** in.	L Floor to Aquastat in.	M Floor to Aquastat Avg Bulb in.	N Floor to Drain Valve in.	Std. Shipping Weight* in.	ASME Shipping Weight* lbs.
CF-38-3	50 ³ / ₈	28 ¹ / ₄	8	40 ³ / ₄	12 ³ / ₈	26	41 ¹ / ₂	-	50 ³ / ₈	38 ⁵ / ₈	35	-	21 ³ / ₄	428	-
CF-80-3	72 ³ / ₄	30 ¹ / ₄	8	62 ³ / ₈	12 ³ / ₈	34 ¹ / ₄	62 ³ / ₈	-	72 ¹ / ₄	44 ⁷ / ₈	43 ³ / ₈	62 ³ / ₈	27 ⁷ / ₈	850	875
CF-100-3	73 ¹ / ₄	30 ¹ / ₄	8	62 ³ / ₈	11 ³ / ₈	29 ⁵ / ₈	62 ³ / ₈	72 ³ / ₄	72 ¹ / ₄	44 ¹ / ₈	36 ⁷ / ₈	62 ³ / ₈	29 ⁵ / ₈	760	798

Model Number	A Floor to Flue Conn. mm.	B Jacket Dia. mm.	C Vent Size mm.	D Floor to T&P Conn. mm.	E Floor to C/L Burner Opening mm.	F Front / Rear Cold Water Conn. mm.	G Front / Rear Hot Water Conn. mm.	H Floor to Top Water Conn. mm.	J Floor to Heater Top mm.	K Depth** mm.	L Floor to Aquastat mm.	M Floor to Aquastat Avg Bulb mm.	N Floor to Drain Valve mm.	Std. Shipping Weight* kg.	ASME Shipping Weight* kg.
CF-38-3	1280	718	203	1035	314	660	1054	-	1280	981	889	-	552	194	-
CF-80-3	1848	768	203	1584	321	870	1584	-	1835	1140	1102	1584	708	386	397
CF-100-3	1861	768	203	1584	289	752	1584	1848	1835	1121	937	1584	752	345	362

* Weight does not include burner and controls.

** Depth includes burner dimensions.

Model Number	Water Connections Size Front / Rear / Top			Aquastat and Avg. Bulb Tapping in.	Relief Valve Opening in.	Drain Valve Opening in.
	in.	in.	in.			
CF-38-3	1 ¹ / ₂	1 ¹ / ₂	-	3/4	1	3/4
CF-80-3	1 ¹ / ₂	2	-	3/4	1	3/4
CF-100-3	1 ¹ / ₂	2	-	3/4	1	3/4

Model Number	Water Connections Size Front / Rear / Top			Aquastat and Avg. Bulb Tapping mm.	Relief Valve Opening mm.	Drain Valve Opening mm.
	mm.	mm.	mm.			
CF-38-3	38	30	-	19	25	19
CF-80-3	38	51	-	19	25	19
CF-100-3	38	51	-	19	25	19

Specifications for Commercial Multi Flue Water Heaters

	CF-38	CF-80	CF-100
Tank Capacity Gallons	38	80	100
Number of Flues	11	20	12
Firing Rate Range GPH	1.75 to 2.50	3.50 to 5.00	2.50 to 3.00
Model Number	CF-38-350-3	CF-80-700-3(A)	CF-100-420-3(A)
Firing Rate GPH	2.50	5.00	3.00
Btu/hr Input	350,000	700,000	420,000
Recovery Rate – 100°F Rise	334	665	410
– 90°F Rise	371	740	456
Model Number	CF-38-315-3	CF-80-630-3(A)	CF-100-350-3(A)
Firing Rate GPH	2.25	4.50	2.50
Btu/hr Input	315,000	630,000	350,000
Recovery Rate – 100°F Rise	304	608	355
– 90°F Rise	338	676	395
Model Number	CF-38-280-3	CF-80-560-3(A)	–
Firing Rate GPH	2.00	4.00	–
Btu/hr Input	280,000	560,000	–
Recovery Rate – 100°F Rise	273	543	–
– 90°F Rise	304	604	–
Model Number	CF-38-245-3	CF-80-490-3(A)	–
Firing Rate GPH	1.75	3.50	–
Btu/hr Input	245,000	490,000	–
Recovery Rate – 100°F Rise	240	483	–
– 90°F Rise	267	537	–
T&P Valve	Installed	Installed	Included
Dual Aquastat	Installed	Installed	Installed
Maximum Operating Temperature	180°F	180°F	180°F
Flue Collar Size	8"	8"	8"
Number of Anodes	3	4	4
Water Connection Location	Front	Front	Front & Top
Water Connection Type	1½" Male NPT	1½"	1½" & 1½"
Auxillary Connections Location	Rear – 1½"	Rear – 2"	Rear – 2"
Auxillary Connections Type	1½" Female NPT Capped	2" Capped	2" Capped
Hand Hole Clean Out	Included	Included	Included
Water Heater Shipping Weight – lbs.	428	850	768
Water Heater Height	50¾"	72¼"	72¼"
Water Heater Shipping Weight (ASME)– lbs.	-	875	798
Water Heater Diameter	28¼"	30¼"	30¼"
Water Heater Packaging	TriWall Carton	Wood Crate	Wood Crate

(A) ASME Construction available for CF-80 and CF-100 only.

For ASME construction add "A" to the model number as displayed (Ex. CF-80-490-3A).

These models meet or exceed the Thermal Efficiency and Standby Loss Requirements of ASHRAE 90.1b (current edition).

All models are design certified for up to 180°F. (82°C) application as an Automatic Storage Heater, and an Automatic Circulating Tank Heater.

As an Automatic Storage Heater, all models are complete self-contained water heating systems. It needs no separate storage tank, pump, wiring or elaborate piping network. When equipped with a mixing valve, it will supply 180°F (82°C) sanitizing and 140°F (60°C) general purpose hot water simultaneously. These models can be used either as a single unit or in multiples connected in parallel.

Sample Specification

The water heater shall be a Bradford White model _____ with a rated storage capacity of not less than _____ gallons, a minimum input of _____ BTUH/KW, a firing rate of _____ GPH/LPH, and a minimum recovery of _____ GPH/LPH at 100°F (56°C). temperature rise. It shall be design certified for 180°F (82°C). application, either with or without a separate storage tank. The tank shall be lined with Vitraglas® vitreous enamel and shall have a bolted hand hole cleanout. The tank shall have multiple extruded magnesium anode rods installed in separate head couplings and extended to within three inches (76mm) of the bottom. This water heater shall be equipped with 304L stainless steel cold water inlet, Hydrojet® Sediment Reduction System, an ASME rated T&P relief valve and a flame retention high speed oil burner (115V AC required). The entire installation shall be made in compliance with state and local codes and ordinances.

Dimensions and specifications subject to change without notice in accordance with our policy of continuous product improvement.



For U.S. and Canada field service,
contact your professional installer or
local Bradford White sales representative.

Sales/800-523-2931
Fax/215-641-1670

Technical Support/800-334-3393
Fax/269-795-1089

Warranty/800-531-2111
Fax/269-795-1089

International:
Telephone/215-641-9400
Telefax/215-641-9750



Sales/Technical Support
866-690-0961
905-238-0100
Fax/905-238-0105

www.bradfordwhite.com

Built to be the Best™